

Crash Analysis Studio

Episode 1: Indianapolis, IN

**STRONG
TOWNS**

Police Crash Report

- Fatal crash occurred at the intersection of East 86th Street and Monon Trail.
- Crash occurred at 8:26 AM.
- Cloudy skies.
- Roadway surface reported as dry.

Police Crash Report

- Driver traveling west on East 86th Street in the left lane.
- Victim traveling north along Monon Trail by bike.
- Driver crossed through the intersection and struck the victim on the far west side.

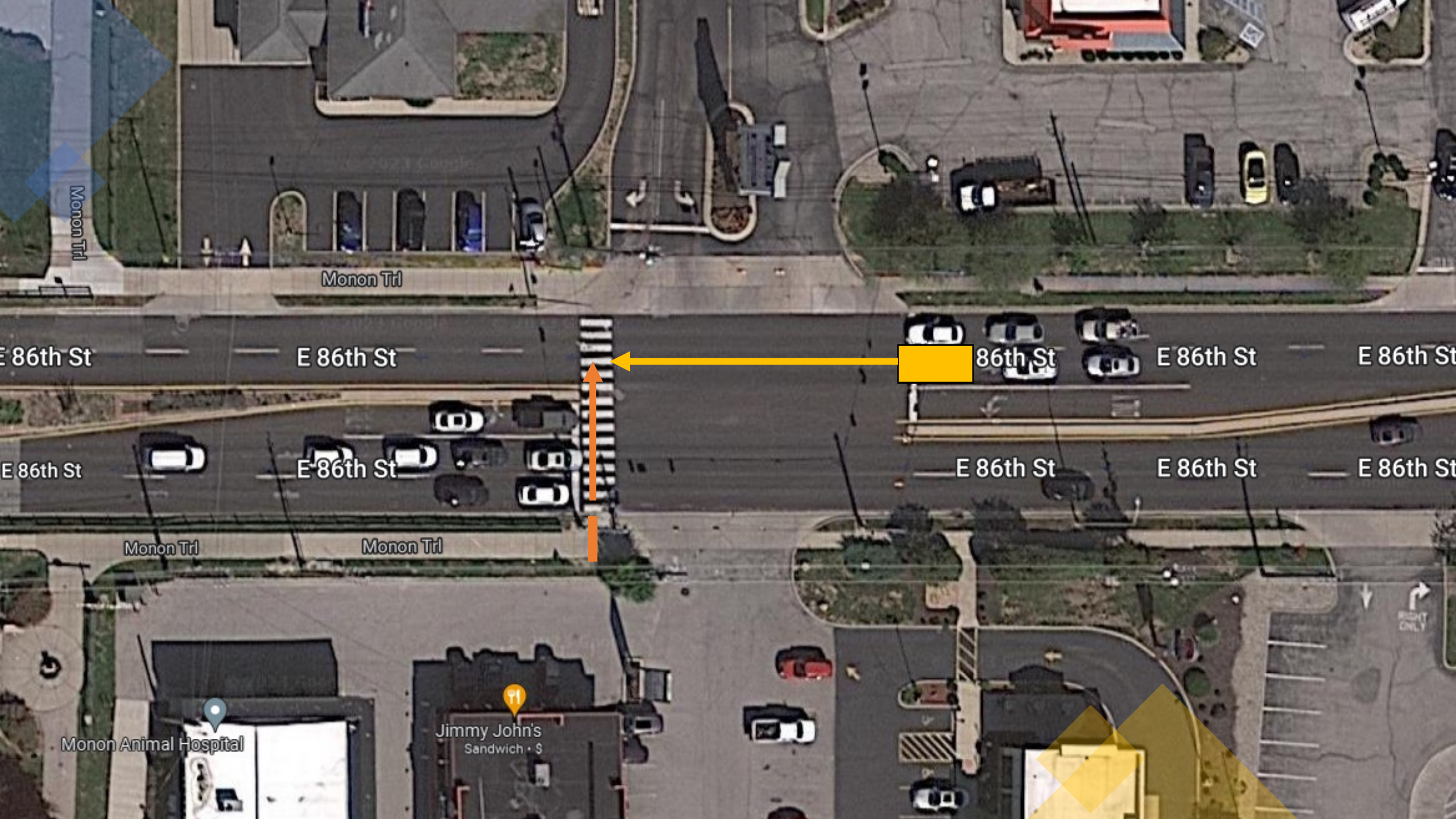

Monon Trl

Monon Trl

E 86th St

E 86th St

86th St

E 86th St

E 86th St

E 86th St

E 86th St

E 86th St

E 86th St

E 86th St

Monon Trl

Monon Trl

Monon Animal Hospital

Jimmy John's
Sandwich · S

Police Crash Report

- Driver claims the traffic signal was green when the vehicle entered the intersection.
- Three witnesses indicate the signal was red when the driver entered the intersection.
- The Police Crash Report indicates the Primary Factor as “Disregard Signal.”
- There are no indications that impairment from alcohol or drug use was involved. The driver was administered a blood test.

Overall Site Conditions

- East 86th Street is a stroad environment
 - Lanes are 11 feet wide.
 - Enforced speed limit is 35 mph.
 - Frequent intersections with turning movements.
 - Turn lanes to facilitate through traffic.

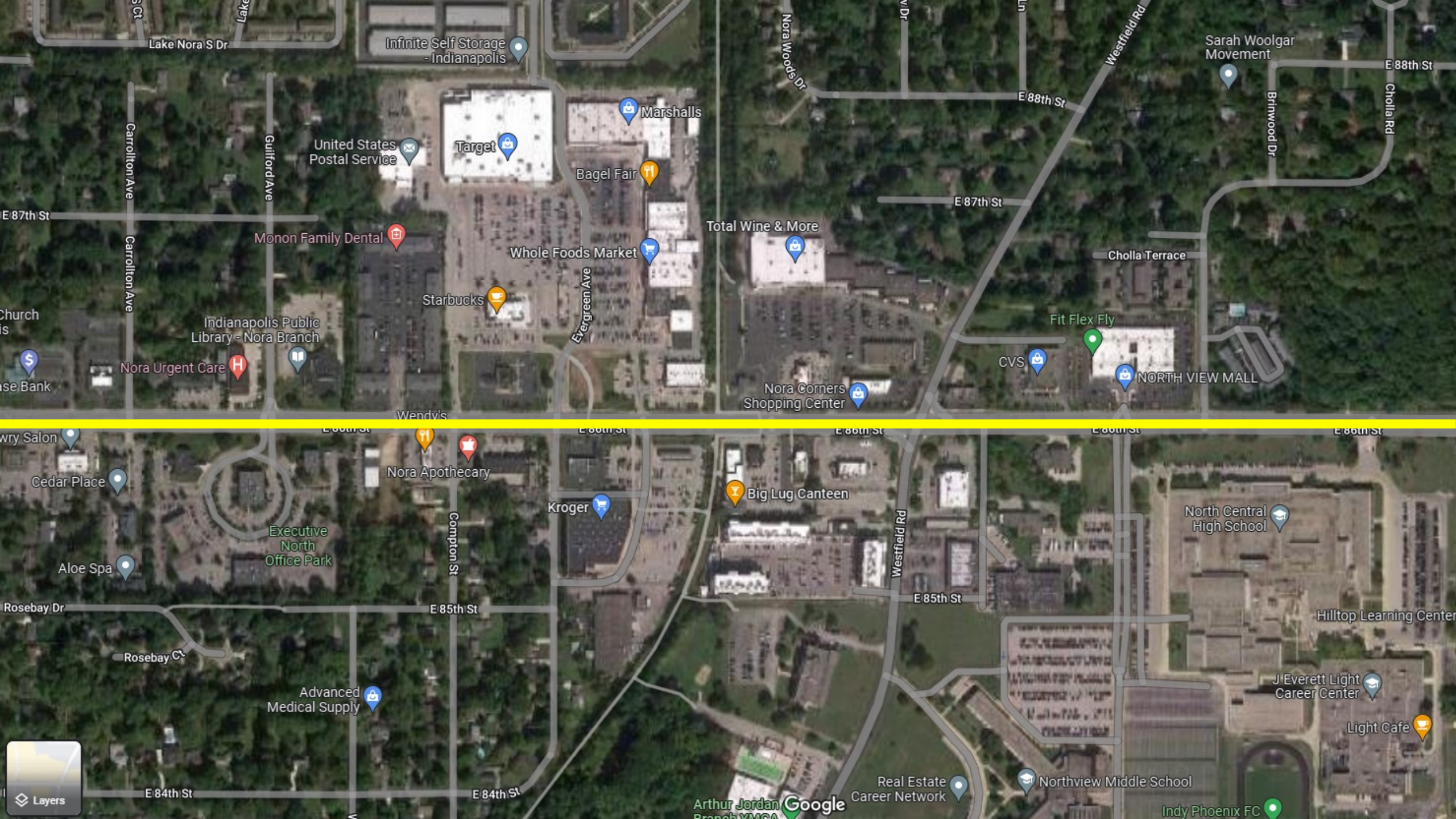

Lake Nora S Dr

Infinite Self Storage - Indianapolis

Sarah Woolgar Movement

Target

Marshalls

United States Postal Service

Bagel Fair

Total Wine & More

Whole Foods Market

Starbucks

Monon Family Dental

Indianapolis Public Library - Nora Branch

Fit Flex Fly

Cholla Terrace

Nora Urgent Care

CVS

NORTH VIEW MALL

Nora Corners Shopping Center

Wendy's

wry Salon

Nora Apothecary

Big Lug Canteen

North Central High School

Cedar Place

Kroger

Compton St

Westfield Rd

Hilltop Learning Center

Rosebay Dr

E 85th St

E 85th St

J Everett Light Career Center

Light Cafe

Advanced Medical Supply

Real Estate Career Network

Northview Middle School

Layers

E 84th St

E 84th St

Arthur Jordan Branch YMCA

Indy Phoenix FC

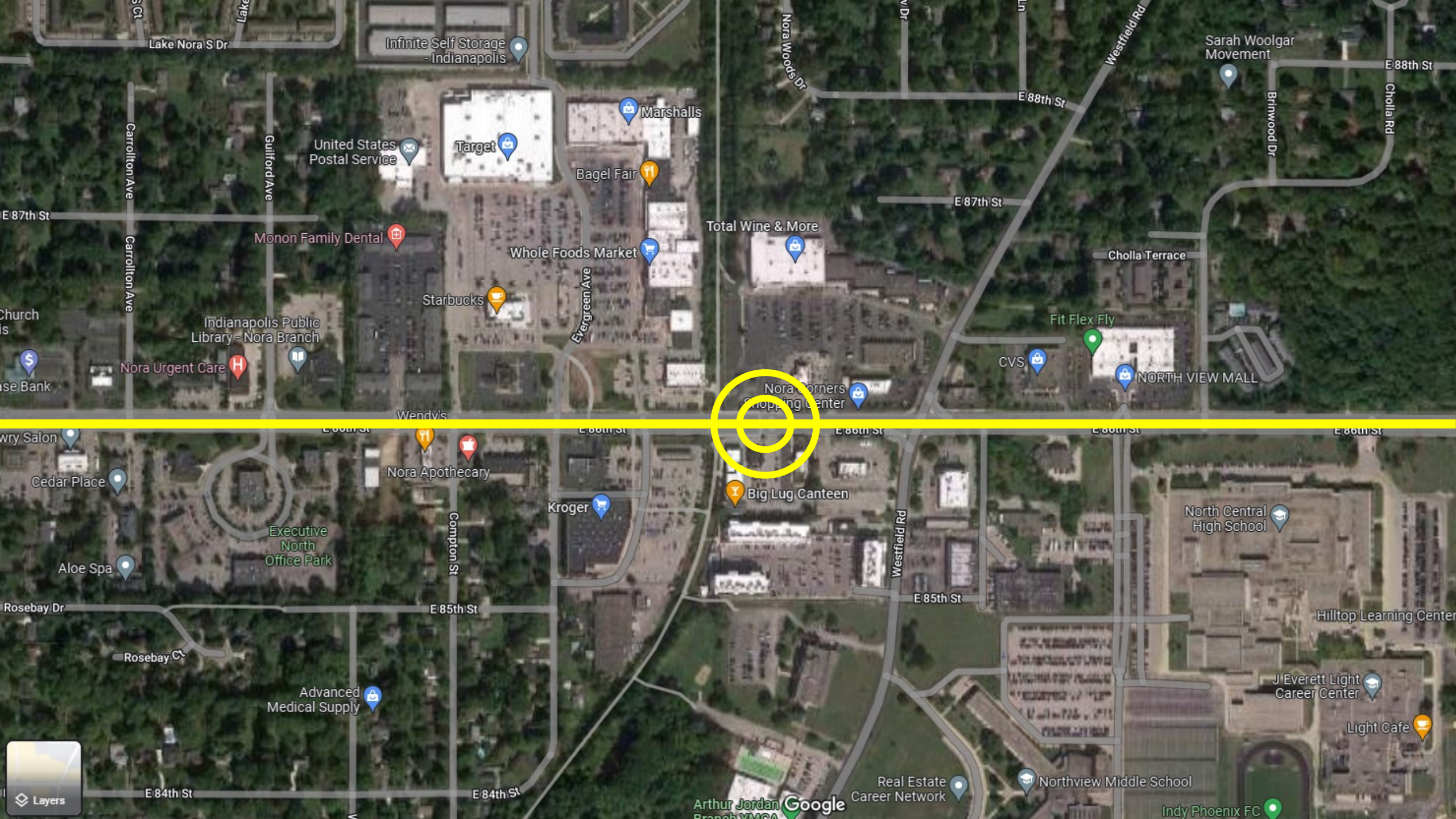

Lake Nora S Dr

Infinite Self Storage - Indianapolis

Sarah Woolgar Movement

Carrollton Ave

Gulford Ave

United States Postal Service

Target

Marshalls

E 88th St

Brimwood Dr

E 88th St

Cholla Rd

E 87th St

Monon Family Dental

Bagel Fair

E 87th St

Total Wine & More

Cholla Terrace

Whole Foods Market

Starbucks

Indianapolis Public Library - Nora Branch

Evergreen Ave

Fit Flex Fly

CVS

NORTH VIEW MALL

Nora Urgent Care

Nora Corners Shopping Center

Wendy's

E 86th St

E 86th St

E 86th St

E 86th St

E 86th St

E 86th St

Wry Salon

Cedar Place

Nora Apothecary

Kroger

Big Lug Canteen

North Central High School

Aloe Spa

Executive North Office Park

Compton St

Westfield Rd

Rosebay Dr

E 85th St

E 85th St

Hilltop Learning Center

Rosebay Ct

Advanced Medical Supply

J Everett Light Career Center

Light Cafe

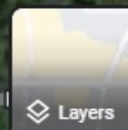

Layers

E 84th St

E 84th St

Arthur Jordan Branch YMCA

Google

Real Estate Career Network

Northview Middle School

Indy Phoenix FC



E 86th St

Chipotle

RESTAURANT

Overall Site Conditions

- Monon Trail is the backbone of a regional trail network.

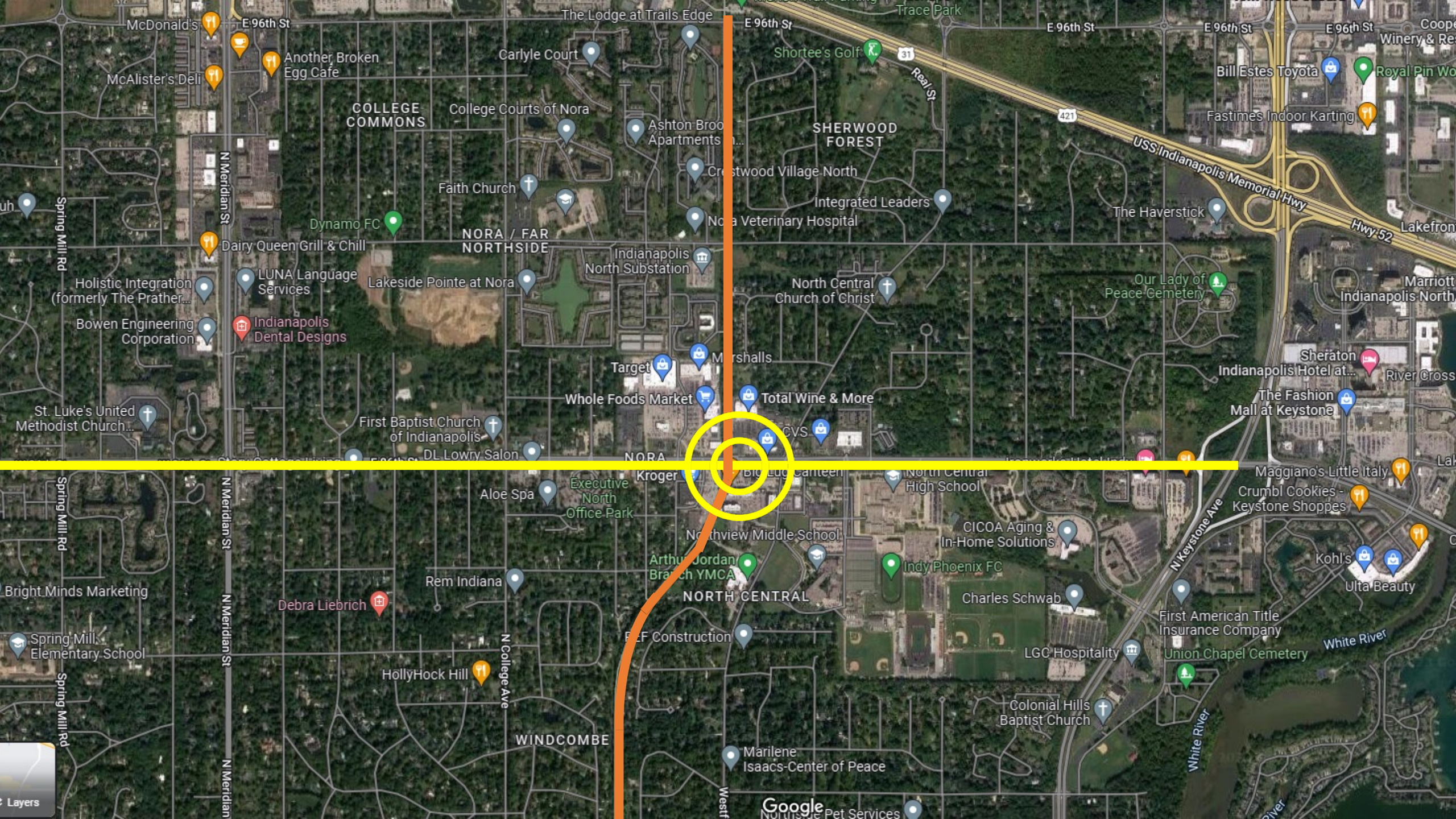

COLLEGE COMMONS

College Courts of Nora

SHERWOOD FOREST

NORA / FAR NORTHSIDE

NORTH CENTRAL

WINDCOMBE

Target

Whole Foods Market

Kroger

Total Wine & More

Arthur Jordan Branch YMCA

CICOA Aging & In-Home Solutions

Indy Phoenix FC

Charles Schwab

LGC Hospitality

Colonial Hills Baptist Church

Sheraton Indianapolis Hotel at...

The Fashion Mall at Keystone

Maggiano's Little Italy

Crumb Cookies - Keystone Shoppes

Kohl's

Ulta Beauty

First American Title Insurance Company

Union Chapel Cemetery

Google





Overall Site Conditions

- Land use pattern along East 86th Street is auto-oriented
- Anchor Stores
 - Target, Marshalls, Whole Foods, Kroger, North View Mall
- Drive-through businesses
 - Starbucks, Hardees, Jimmy John's, Taco Bell, Steak 'n Shake
- Office Park and various retail/office uses
- High school, Middle school, YMCA

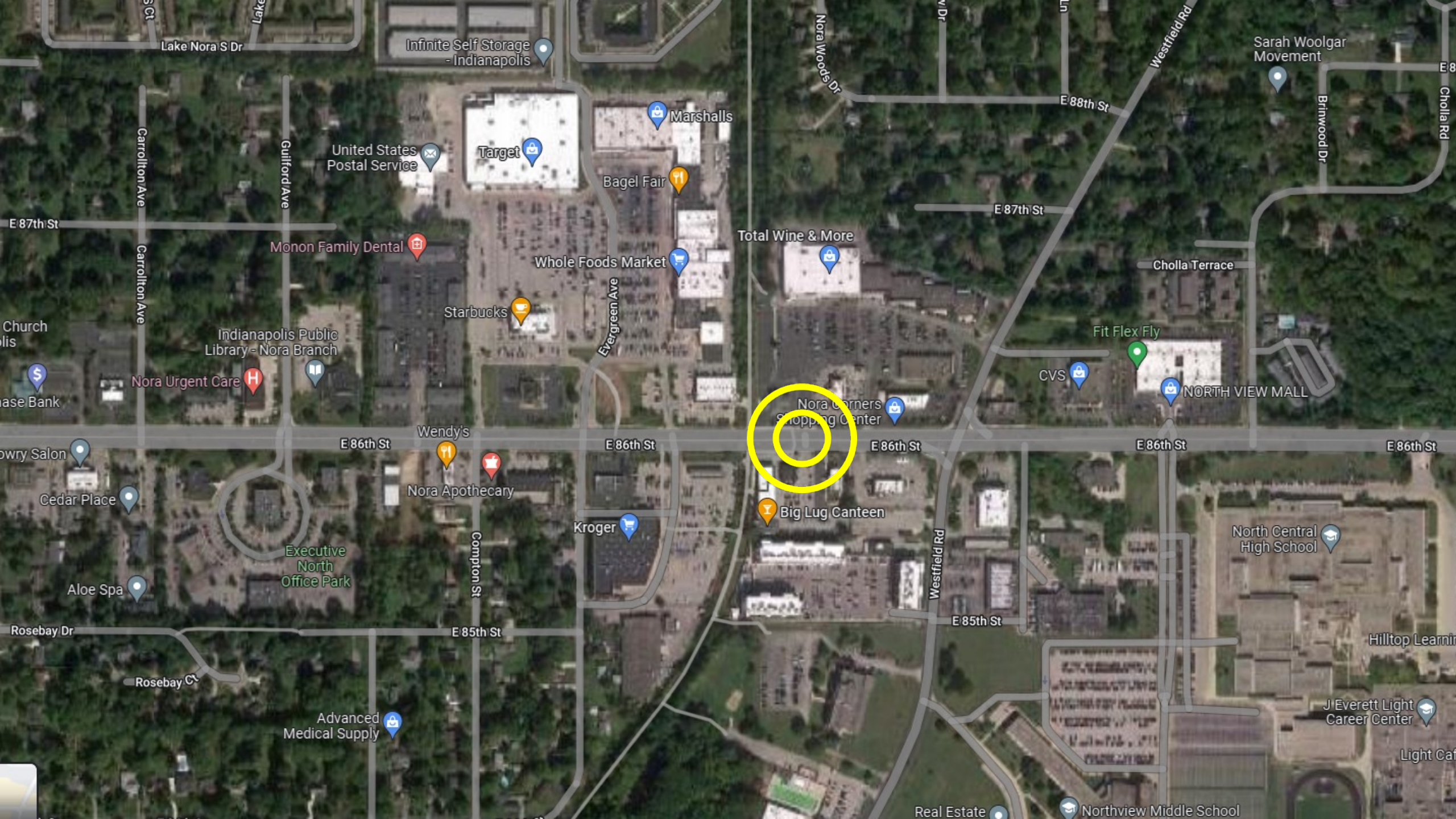

Overall Site Conditions

- Surrounding land use is predominantly residential

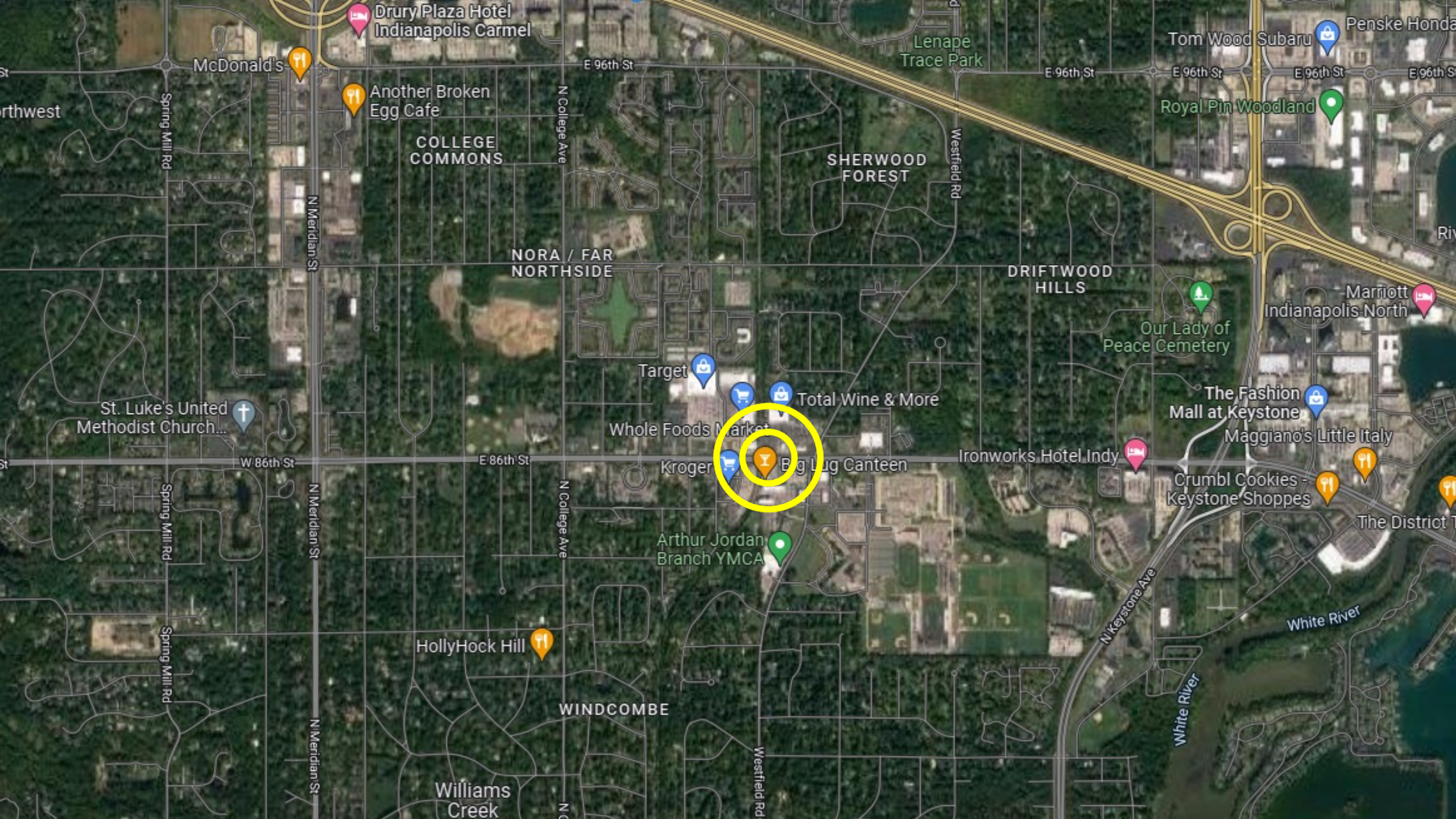

Drury Plaza Hotel
Indianapolis Carmel

McDonald's

Another Broken
Egg Cafe

COLLEGE
COMMONS

SHERWOOD
FOREST

NORA / FAR
NORTHSIDE

DRIFTWOOD
HILLS

Royal Pin Woodland

Tom Wood Subaru

Penske Honda

St. Luke's United
Methodist Church...

Target

Total Wine & More

Whole Foods Market

The Fashion
Mall at Keystone

Maggiano's Little Italy

Kroger

Big Lug Canteen

Ironworks Hotel Indy

Crumbl Cookies -
Keystone Shoppes

Arthur Jordan
Branch YMCA

HollyHock Hill

WINDCOMBE

Williams
Creek

White River

White River

N Keystone Ave

Spring Mill Rd

N Meridian St

N College Ave

Westfield Rd

Spring Mill Rd

N Meridian St

N College Ave

Spring Mill Rd

N Meridian St

N College Ave

Westfield Rd

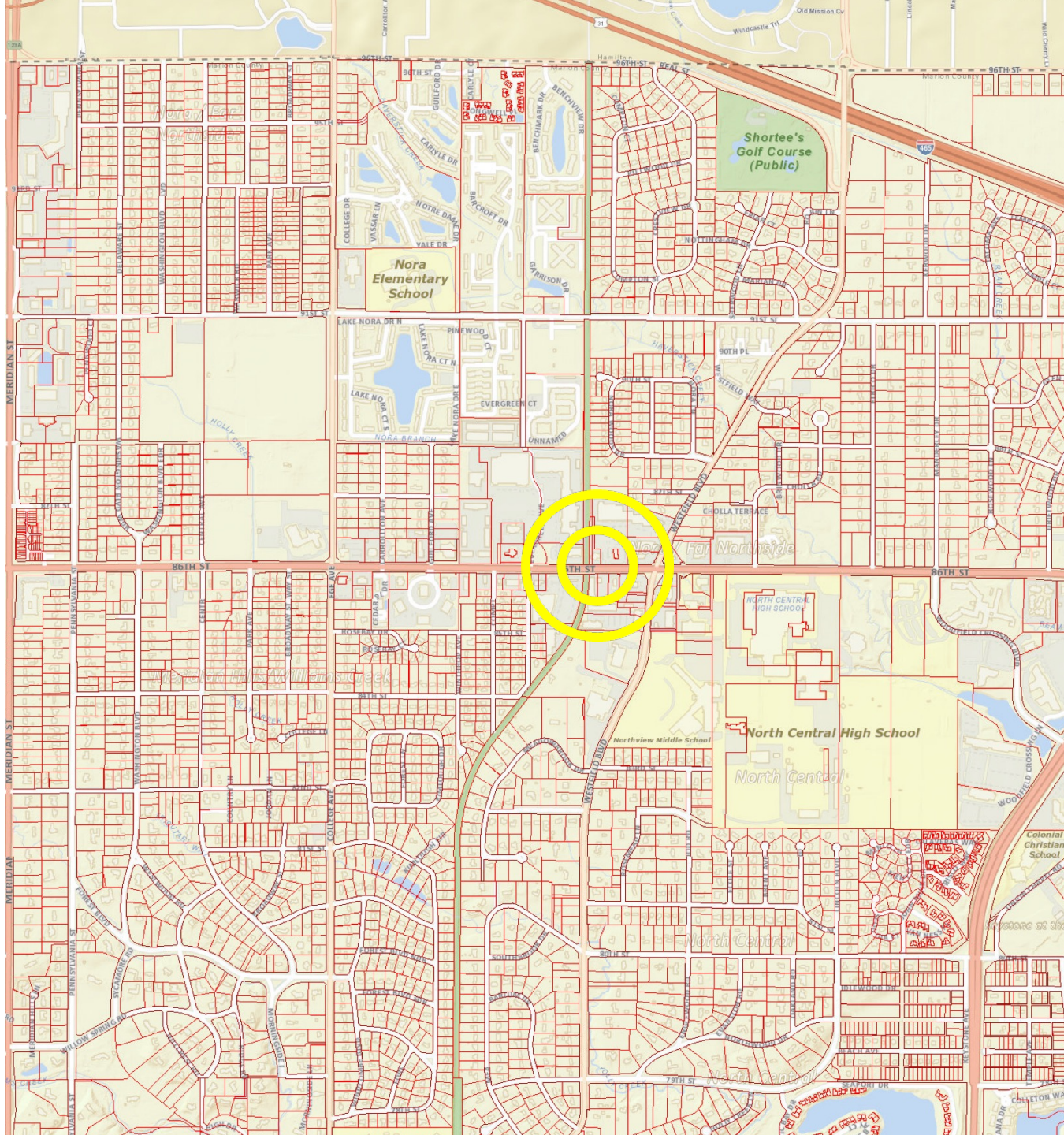

Overall Site Conditions

- Preliminary Speed Study indicates significant number of automobiles traveling at fatal speeds

The effects of higher speed limits on traffic fatalities in the United States, 1993–2017.

-Insurance Institute for Highway Safety

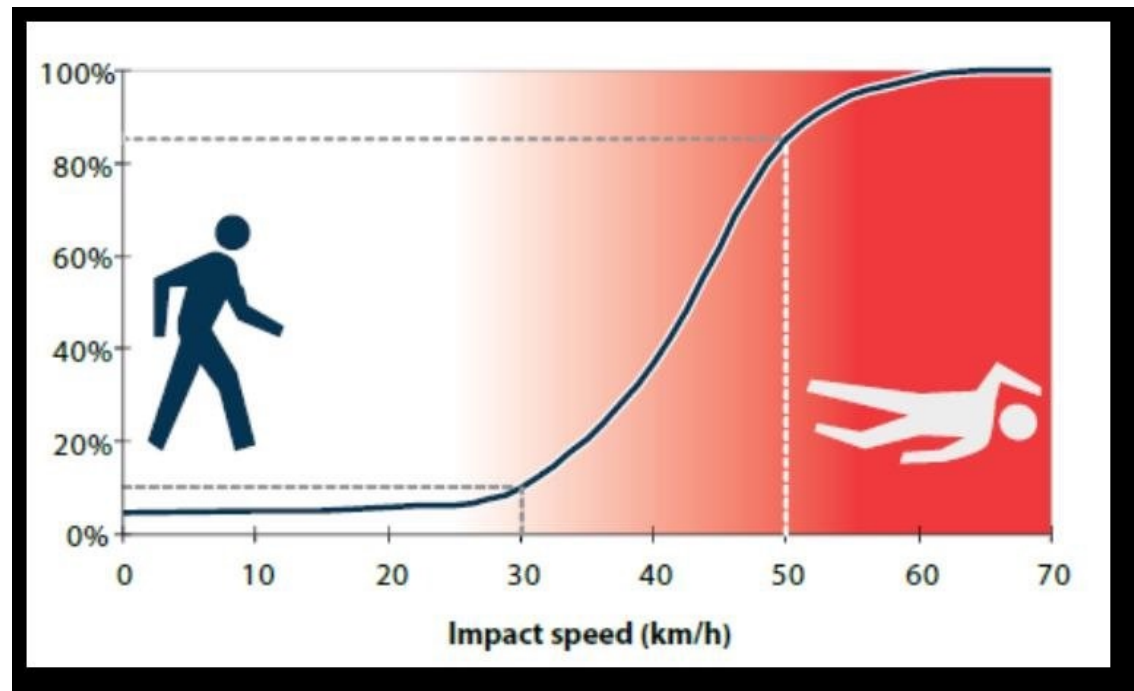

86th & Monon Trail Speed Study - Indianapolis

Number of Vehicles Driving at Each Speed

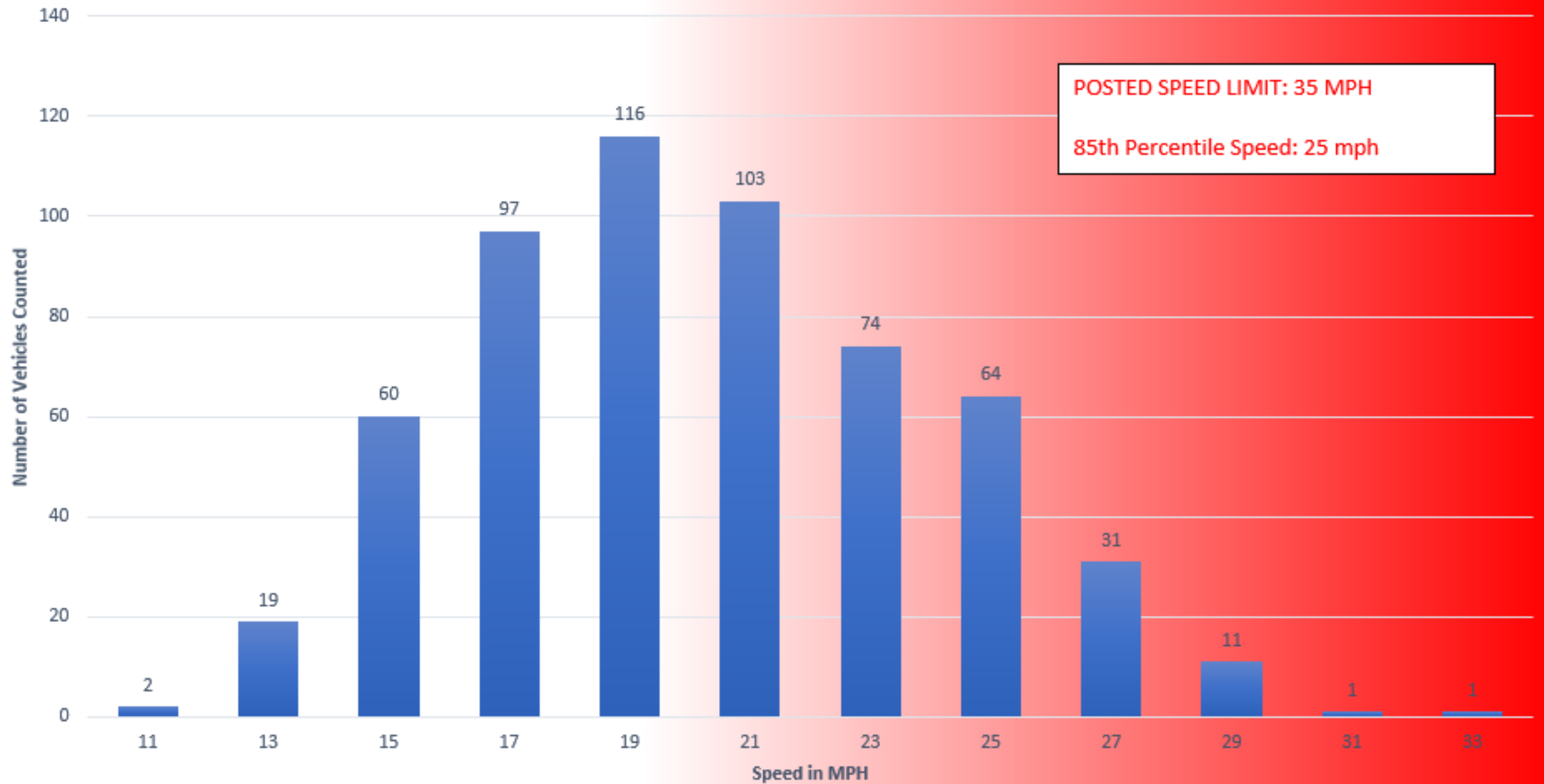

Intersection Approach Conditions (auto)

- Center concrete separation median (no refuge)
- Two lanes of traffic moving in the same direction
- Multiple access points with in-out turning movements (no crossovers)
- Sidewalks directly adjacent driving surface
- Electric poles adjacent to the sidewalks
- Turf and trees of medium height adjacent to the sidewalks



© 2023 Google

© 2023 Google

E 86th St

Intersection Approach Conditions (bike)

- Trail merges into sidewalk parallel to East 86th Street
- Wooden separation fence (non-collision resistant) between sidewalk and East 86th Street



BMO Harris bank

S' ice cream

Intersection Conditions (auto)

- Left turn lanes in both east and west approaches
- Center concrete separation median diminishes (no refuge)
- Two lanes of traffic moving in the same direction
- Wide curb radius on north access point (Nora Corners)
- North access designed to accommodate two vehicles in each direction
- 85-foot total north access width

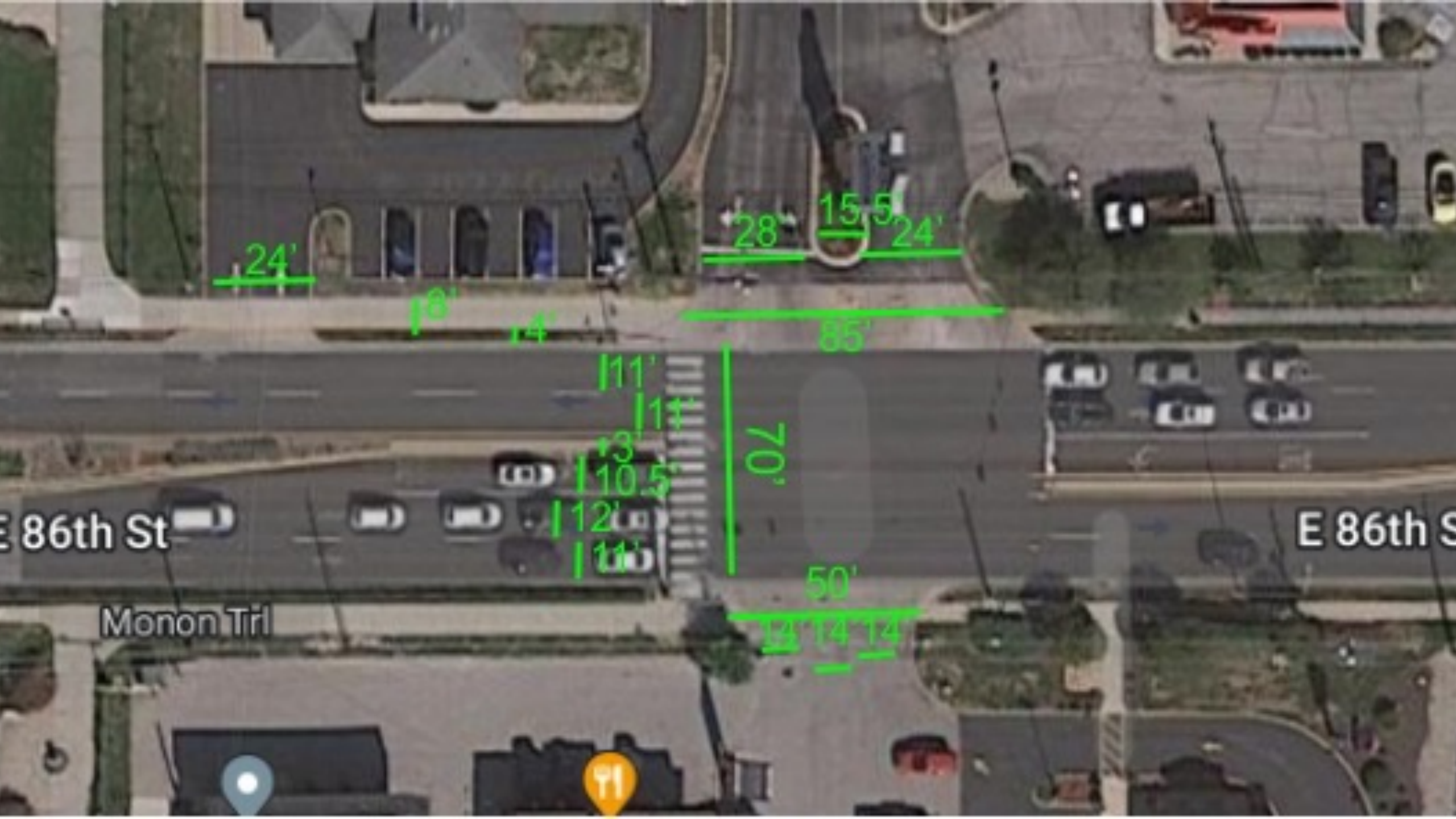

24'

18'

14'

28'

15.5'

24'

85'

11'

11'

13'

10.5'

12'

11'

70'

50'

13'

14'

14'

E 86th St

E 86th St

Monon Trl



Intersection Conditions (auto)

- Sidewalks blend with driving surface
- No crosswalks on east (near) side of intersection
- Crosswalk present on west (far) side of intersection
- Pedestrian signage hung from wire
- Electric poles adjacent to the sidewalks
- Traffic signals hung from wires



ONLY



United
MOTOR

RA CENTER

86th

Intersection Conditions (trail)

- 70 feet of total crossing, no refuge
 - Two lanes of through traffic traveling east
 - One lane of left-turning traffic traveling north into Nora Corners
 - Two lanes of through traffic traveling west
- Crosswalk present on west side of intersection
- Permission button on pole coordinated with signal
- Long signal interval, excessive wait time



JoePa
Interior

PUSH
BUTTON
FOR



12
15
17
18
19
20
21
22
23
24
25
26
27
28
29
30
31
32
33
34
35
36
37
38
39
40
41
42
43
44
45
46
47
48
49
50
51
52
53
54
55
56
57
58
59
60
61
62
63
64
65
66
67
68
69
70
71
72
73
74
75
76
77
78
79
80
81
82
83
84
85
86
87
88
89
90
91
92
93
94
95
96
97
98
99
100

